

CLP5015WBZ
PDL5015WBZ

Wiser™ Micro Module

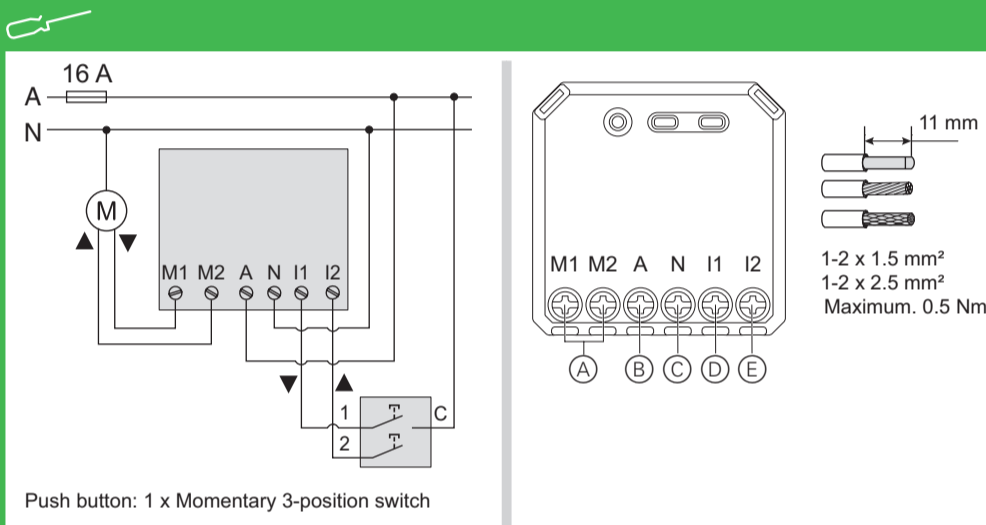

4 A, $\cos\phi = 0.6 - 1.0$

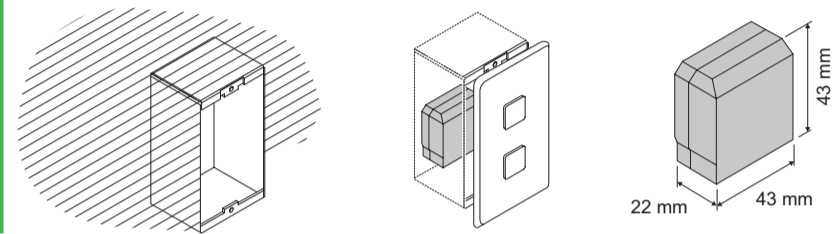

Pairing

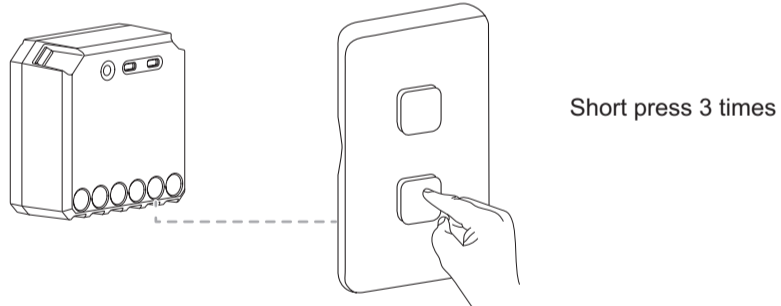

Restoring the device to factory default

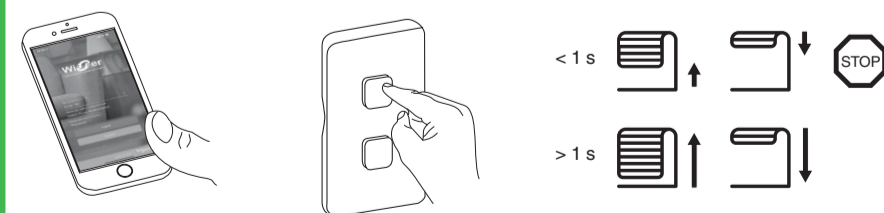
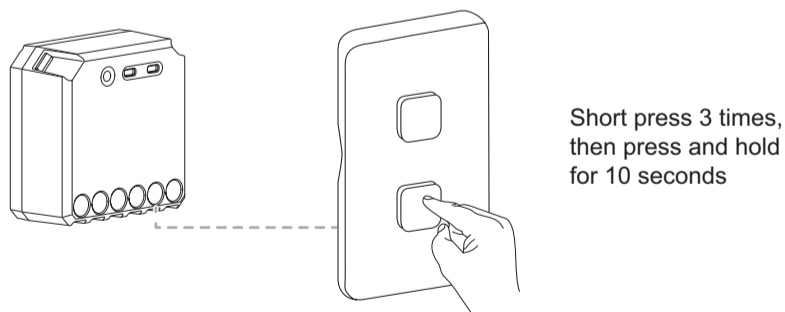

Wiser Micro Module Blind

Prerequisites

Download the **Wiser™ by SE App** to your smartphone and install the **Wiser Hub** to configure and control Wiser devices.

Additional system information

Detailed product information is available online in the **system user guide**: Scan the QR code for your region.

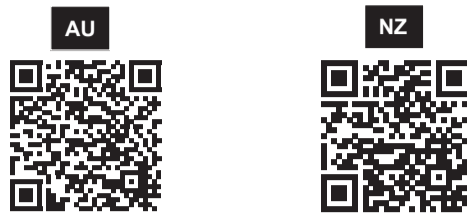

For your safety

⚠️ DANGER

HAZARD OF ELECTRIC SHOCK, EXPLOSION, OR ARC FLASH

- It is illegal for persons other than an appropriately licensed electrical contractors or other persons authorised by legislation to work on the fixed wiring of any electrical installation.
- To comply with all safety standards, the product must be used only for the purpose described in this instruction and must be installed in accordance with the wiring rules and regulation in the location where it is installed.
- Lock out and tag the input circuit before accessing the wiring connections.
- There are no user serviceable parts inside the product.

Failure to follow these instructions will result in death or serious injury.

Getting to know the product

The Wiser micro module blind (hereinafter referred to as **blind controller module**) is used to control one blind/roller shutter motor equipped with an end position switch.

Relay contacts are mechanically locked against each other to prevent simultaneous triggering of two relay outputs.

The blind controller module must not be used to control safety relevant applications.

Control options

Home control: To control the blind controller module in your home through the **Wiser by SE App**, you need the Wiser Hub.

Direct operation: The blind controller module can always be controlled directly on-site. To do this, you can connect a maximum of 10 push buttons (see "Push button reference").

Functions:

- Mechanical and electronic locking
- Setting a timer or a time schedule (via App)
- Setting the running time (via App)

Push button reference

Description	Catalogue numbers
Momentary push button	41EPBM-VW, 356PBSS-VW
Mechanical push button	60PBBP, 30PBBP
Momentary 3-position switch	P49MBPR-XW + 49T-VW, P387M3TM-XW + 387A3T-VW

Choosing the installation location

If you place the blind controller module behind a push button, use a suitable wall box.

Connection elements

- (A) Motor contacts (up/down)
- (B) Active conductor
- (C) Neutral conductor
- (D) Extension unit input 1
- (E) Extension unit input 2

Mounting the blind controller module

Connecting the blind controller module

⚠️ DANGER

HAZARD OF ELECTRIC SHOCK

- Make sure that the terminal connection area does not come in contact with the metallic parts of any device installed in the same location.
- Do not short the outputs to neutral.
- The motor contacts and active conductor connection must be separated from one another by a 240 VAC basic insulation.
- When working on the device, always disconnect the device from the power supply, as the output may carry electrical current even when the load is switched off.
- Isolate the incoming circuit before installation, maintenance, or service (or replacement of the load) of the device.

Failure to follow these instructions will result in death or serious injury.

Setting the blind controller module

Pairing to the Wiser Hub

Short press (< 0.5 s) any connected push-button switch 3 times to connect to the available Zigbee network.

Resetting the blind controller module

Short press (< 0.5 s) any connected push-button switch 3 times and then long press the push-button switch once for >10 s and <15 s to reset the blind controller module to factory default mode.

All configuration data, user data, and network data are deleted. After which:

- No connectivity to other devices or rooms
- No time schedule (s)

Operating the blind controller module

You can remotely control the blind controller module through the **Wiser by SE App** or locally by using a momentary switch.

Troubleshooting

Refer to the system user guide.

Technical data

Nominal voltage	AC 220-240 V, 50/60 Hz
Nominal current	4 A, $\cos\phi = 0.6 - 1.0$
Blind channel	1, mechanically and electronically locked against each other
Standby	Maximum 0.4 W
Operating Temperature	0 °C to 35 °C
Neutral conductor	Required
Connecting terminals	Maximum 2 x 2.5 mm ² , solid or stranded types
Extension connection	Maximum 10 push buttons
Length of all cable sections	Maximum 50 m for 3-wire NYM cable
Fuse protection	16 A circuit breaker
Operating frequency	2405 - 2480 MHz
Max. radio-frequency power transmitted	<10 mW
IP rating	IP20
Product dimensions (H x W x D)	43 x 43 x 22 mm
Wall box dimension	The wall box must have a minimum depth of 70 mm.
Certification	Zigbee 3.0
Compliance	

Trademarks

- Zigbee® is a registered trademark of the Zigbee Alliance.
- Apple® and App Store® are brand names or registered trademarks of Apple Inc.
- Google Play™ Store and Android™ are brand names or registered trademarks of Google Inc.
- Wiser™ is a trademark and the property of Schneider Electric SE, its subsidiaries and affiliated companies.

Other brands and registered trademarks are properties of their relevant owners.

Customer care

Warranty information

We warrant this product for 2 years. See **Warranty** links below.

Schneider Electric (Australia) Pty Ltd

33-37 Port Wakefield Road, Gepps Cross SA 5094

Customer Care: 13 73 28

Email: customercare.au@se.com

Warranty:

<https://www.se.com/au/en/about-us/legal/terms-and-conditions.jsp>

www.se.com

Schneider Electric (NZ) Ltd

Building 6, 60 Highbrook Drive, East Tamaki, Auckland 2013

Customer Care: 0800 652 999

Email: sales@nz.schneider-electric.com

Warranty:

<https://www.se.com/nz/en/about-us/legal/terms-and-conditions.jsp>

www.se.com